

**INCORRECT**  
**SUCTION PIPING ARRANGEMENT**

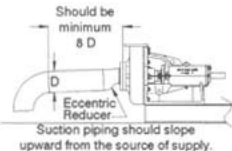

**CORRECT**  
**SUCTION PIPING ARRANGEMENT**

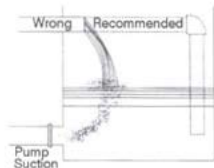

To minimize air entering fluid at the pump suction and to facilitate fluid mixing, the fluid return should be away from the suction and below the fluid level.

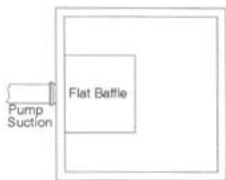

**EXAMPLE 1 (Plan View)**

Vortex at pump suction can be prevented by proper baffle arrangements. Two examples are shown here.

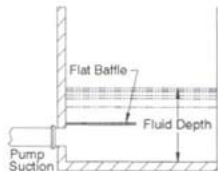

**EXAMPLE 1 (Side View)**

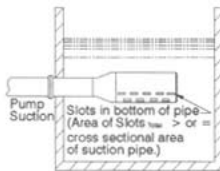

**EXAMPLE 2 (Side View)**